

- Tube Fitting (Double Ferrule)-  
Tube To Female Pipe Thread

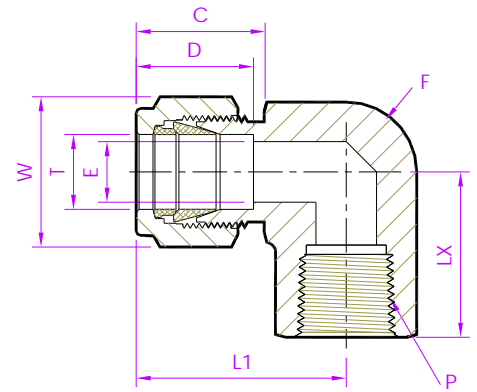

# Female Elbow

Fractional Tube x NPT (M)

Tubefit Part No.	Equivalent Part No. Type 1	Equivalent Part No. Type 2	TUBE OD Ø T	NPT Female Pipe Size P	ØE	D	C	L1	LX	Body Hex F	Nut Hex W
Dimensions in Inches											
1 - FED - 1N	- 100 - 8 - 1	1FEL1N	1/16	1/16	0.05	0.34	0.43	0.71	0.56	7/16	5/16
1 - FED - 2N	- 100 - 8 - 2	1FEL2N		1/8	0.05			0.81	0.75	9/16	
2 - FED - 2N	- 200 - 8 - 2	2FEL2N	1/8	1/8	0.09	0.50	0.60	0.97	0.75	9/16	7/16
2 - FED - 4N	- 200 - 8 - 4	2FEL4N		1/4	0.09			1.08	0.88	11/16	
3 - FED - 2N	- 300 - 8 - 2	3FEL2N	3/16	1/8	0.12	0.54	0.63	1.00	0.75	9/16	1/2
4 - FED - 2N	- 400 - 8 - 2	4FEL2N	1/4	1/8	0.19	0.60	0.70	1.06	0.75	9/16	9/16
4 - FED - 4N	- 400 - 8 - 4	4FEL4N		1/4	0.19			1.17	0.88	11/16	
4 - FED - 6N	- 400 - 8 - 6	4FEL6N		3/8	0.19			1.25	0.88	13/16	
4 - FED - 8N	- 400 - 8 - 8	4FEL8N		1/2	0.19			1.36	1.12	9/16	
5 - FED - 2N	- 500 - 8 - 2	5FEL2N	5/16	1/8	0.25	0.64	0.73	1.13	0.75	9/16	5/8
5 - FED - 4N	- 500 - 8 - 4	5FEL4N		1/4	0.25			1.20	0.88	11/16	
6 - FED - 2N	- 600 - 8 - 2	6FEL2N	3/8	1/8	0.28	0.66	0.76	1.20	0.75	5/8	11/16
6 - FED - 4N	- 600 - 8 - 4	6FEL4N		1/4	0.28			1.23	0.88	11/16	
6 - FED - 6N	- 600 - 8 - 6	6FEL6N		3/8	0.28			1.31	0.88	13/16	
6 - FED - 8N	- 600 - 8 - 8	6FEL8N		1/2	0.28			1.42	1.12	1	
8 - FED - 4N	- 810 - 8 - 4	8FEL4N	1/2	1/4	0.41	0.90	0.86	1.42	0.88	13/16	7/8
8 - FED - 6N	- 810 - 8 - 6	8FEL6N		3/8	0.41			1.42	0.88	13/16	
8 - FED - 8N	- 810 - 8 - 8	8FEL8N		1/2	0.41			1.53	1.12	1	
10 - FED - 6N	- 1010 - 8 - 6	10FEL6N	5/8	3/8	0.50	0.96	0.86	1.50	0.88	15/16	1
10 - FED - 8N	- 1010 - 8 - 8	10FEL8N		1/2	0.50			1.57	1.12	1.1/16	
12 - FED - 8N	- 1210 - 8 - 8	12FEL8N	3/4	1/2	0.62	0.96	0.86	1.57	1.12	1.1/16	1.1/8
12 - FED - 12N	- 1210 - 8 - 12	12FEL12N		3/4	0.62			1.76	1.25	1.3/8	
14 - FED - 12N	- 1410 - 8 - 12	14FEL12N	7/8	3/4	0.72	1.02	0.86	1.76	1.25	1.3/8	1.1/4
16 - FED - 12N	- 1610 - 8 - 12	16FEL12N	1	3/4	0.88	1.23	1.04	1.93	1.25	1.3/8	1.1/2
16 - FED - 16N	- 1610 - 8 - 16	16FEL16N		1	0.88			2.11	1.50	1.11/16	

NOTE : 1)The E Dimension is the minimum opening. 2)Dimension L1, C, D is shown in the finger-tight position.  
3)Dimensions are for reference only and are subject to change 4)NPT thread as per ANSI B 1.20.1.

- ALL PART NUMBERS ARE PROPRIETARY OF THEIR RESPECTIVE OWNERS. -